

HYDRAULIC MAGNETS ARDEN MAGNET



Magnetic power for your construction sites!

Hydraulic magnets are positioned as the optimal solution for sorting and moving metals. Used on excavators from 7 to 40 tonnes, they are mainly used in the areas of demolition, recycling and screening. They are easily connected with one single-acting line at constant flow on a hydraulic excavator like any other tool.

Efficiency, sustainability and productivity is ensured. Different models are available depending on the quick hitch system and the use.

Benefits

- ✓ Aluminum coil to optimize weight
- ✓ Visiting hatch
- ✓ Display for voltage control
- ✓ Flow controller for optimal use and long lasting life.
- ✓ Robust three-phase hydraulic permanent magnet generator without drain, up to 20 bar back pressure



Arden Magnet equipped on a coupler

The range consists of three types of hydraulic magnets:



Arden Magnet with Adapter Plate

Time saving

Stability

Hydraulic magnets with bolted adjustment plate can be mounted directly on the excavator stick or by means of a quick coupler. This assembly makes it easy to equip earthmoving or demolition shovels.



Arden Magnet with Adapter Plate and Teeth

Facility

Longevity

The teeth are specially designed to facilitate the sorting of metals on the ground. In addition, they are equipped with a quick and easy disassembly system to facilitate replacement in the event of wear.



Arden Magnet with Chain

Adaptability

Optimization

The chain hook system allows it to be easily adapted on many machines. The main advantage lies in the optimum ratio between lifting capacity and weight.



Arden Magnet with Adapter plate

Arden Magnet with Adapter Plate and Teeth

Arden Magnet with Chain

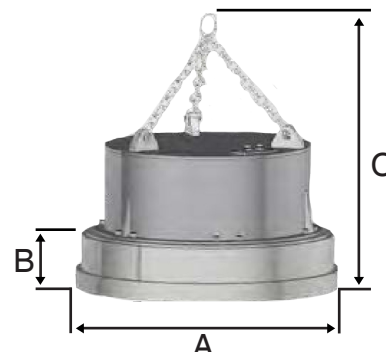
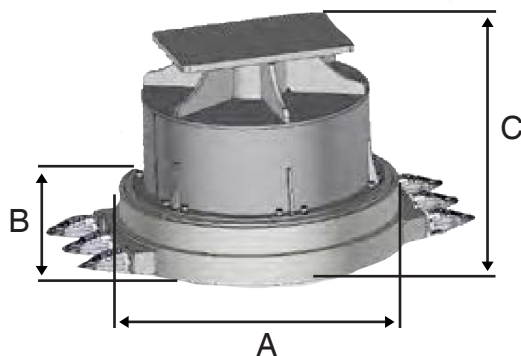
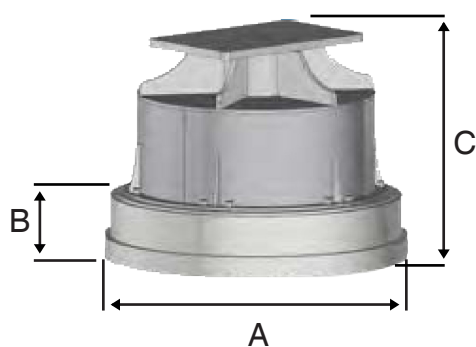

t	Reference	KG	A	B	C	Flow rate**		Maximum pressure ²	Power	Tension
						min	max			
		Kg	mm	mm	mm	L/min	L/min	bar	kW	V
7 - 11	AM200	680	750	245	860	50	150	200	2,6	220
12 - 15	AM300	820	850	245	860	50	150	200	3,4	220
16 - 19	AM400	940	960	260	860	50	150	200	4,5	220
20 - 26	AM500	1400	1140	270	840	70	150	200	6	220
27 - 30	AM550	1700	1260	270	840	70	150	200	7,5	220
30 - 40	AM650	2650	1500	300	870	100	150	200	12	220

* excluding top plate ** For proper operation of the magnet, it is necessary to have a constant flow rate when the machine is in motion.

t	Reference	KG	A***	B***	C***	Teeth		Flow rate**		Maximum pressure	Power	Tension
						Number of teeth	reference	min	max			
		Kg	mm	mm	mm			L/min	L/min	bar	kW	V
7 - 11	AM200T	730	750	245	860	2 teeth x 2 teeth	P303	50	150	200	2,6	220
12 - 15	AM300T	880	850	245	860		P303	50	150	200	3,4	220
16 - 19	AM400T	1030	960	260	860		P303	50	150	200	4,5	220
20 - 26	AM500T	1550	1140	270	840	3 teeth x 3 teeth	P403	70	150	200	6	220
27 - 30	AM550T	1850	1260	270	840		P403	70	150	200	7,5	220
30 - 40	AM650T	2900	1500	300	870		P603	100	150	200	12	220

* excluding top plate ** For proper operation of the magnet, it is necessary to have a constant flow rate when the machine is in motion.

*** does not include teeth

t	Reference	KG	A	B	C	Flow rate**		Maximum pressure ²	Power	Tension
						min	max			
		Kg	mm	mm	mm	L/min	L/min	bar	kW	V
7 - 11	AM200C	600	750	245	1100	50	150	200	2,6	220
12 - 15	AM300C	740	850	245	1100	50	150	200	3,4	220
16 - 19	AM400C	840	960	260	1200	50	150	200	4,5	220
20 - 26	AM500C	1300	1140	270	1350	70	150	200	6	220
27 - 30	AM550C	1600	1260	270	1400	70	150	200	7,5	220
30 - 40	AM650C	2450	1500	300	1450	100	150	200	12	220

* excluding top plate ** For proper operation of the magnet, it is necessary to have a constant flow rate when the machine is in motion.



+33 (0)3 24 33 64 30
 contact@arden-equipment.com
 9 avenue de l'Industrie FR - 08000 Charleville-Mézières
 www.arden-equipment.com

