

# LOADER QUICK HITCH

## AEL



### FEATURES :

Loaders Quick Hitch for excavators from 6 to 34T.

### ADVANTAGES :

- Hydraulic Quick Hitch.
- Compatible with norm ISO.
- Visual locking indicator.

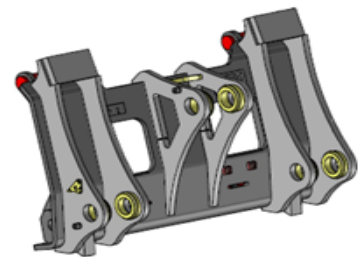
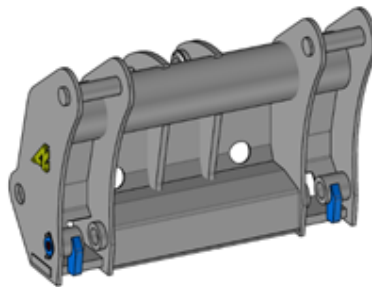
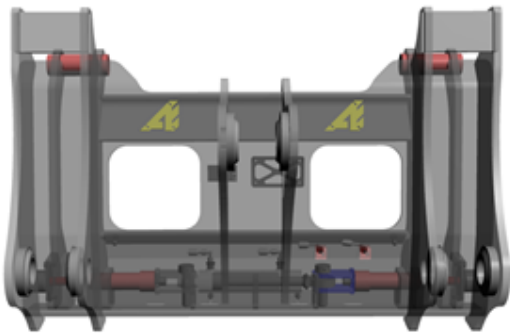
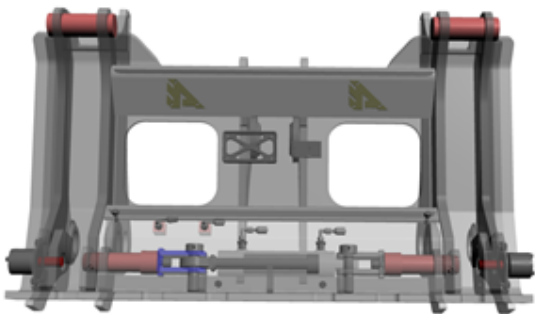

**AEL500/600**

**AEL301/401**

Reference	Machine	Pin (mm)	Top Axis diameter (mm)	Bottom Axis diameter (mm)
AEL301	6 to 12t	616	60	50
AEL401	12 to 20t	616	60	50
AEL500	20 to 28t	765	80	75

