

# NEW GENERATION P103-P453 SERIES 3 TEETH



**A more wear-resistant generation of teeth.**

This new generation of Series 3 teeth has 30% more material than the Series 1 teeth, so you can be sure of a longer service life.

The teeth can be fitted to R05, R10 and R20 backhoe buckets for all excavators from 0.8 to 19 tons and remain **compatible with Series 1 adapters.**



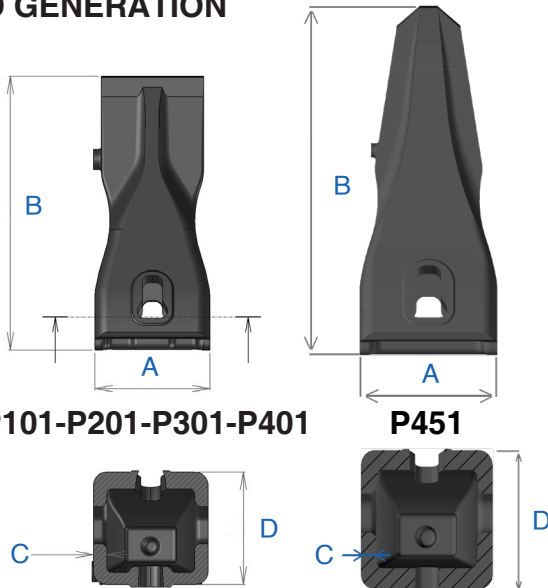

**30% more material** in comparison to Series 1  
*may vary depending on the model*

## OLD GENERATION

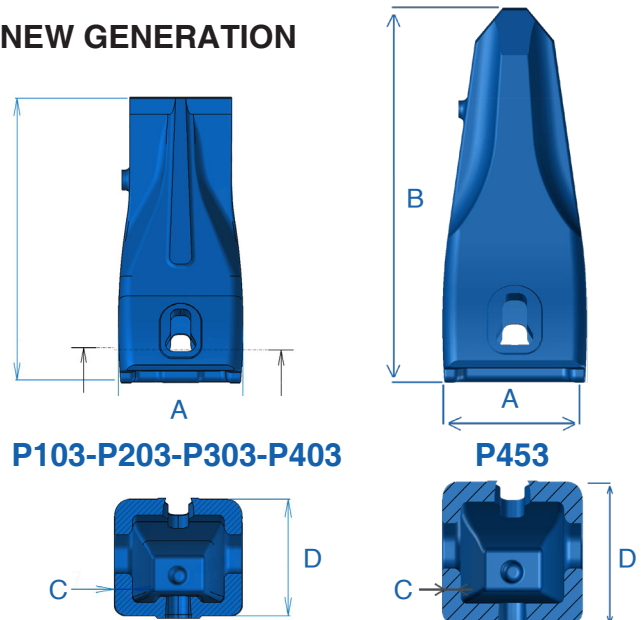

## NEW GENERATION





 t	Reference	 KG	A mm	B mm	C mm	D mm
Older generation	P101	0,43	45	107	5	44
≤ 3	<b>P103</b>	<b>0,60</b>	<b>49</b>	<b>112</b>	<b>7</b>	<b>44</b>
Older generation	P201	0,79	56	134	7	52
3 - 10	<b>P203</b>	<b>1,30</b>	<b>60</b>	<b>145</b>	<b>9</b>	<b>53</b>
Older generation	P301	1,60	67	161	8	72
10 - 15	<b>P303</b>	<b>2,30</b>	<b>71</b>	<b>187</b>	<b>10</b>	<b>72</b>
Older generation	P401	2,85	78	188	10	84
<b>NEW</b> 16 - 19	<b>P403</b>	<b>3,31</b>	<b>82</b>	<b>194</b>	<b>10</b>	<b>84</b>
Older generation	P451	2,52	78	198	9	84
16 - 19	<b>P453</b>	<b>3,60</b>	<b>82</b>	<b>213</b>	<b>11</b>	<b>84</b>

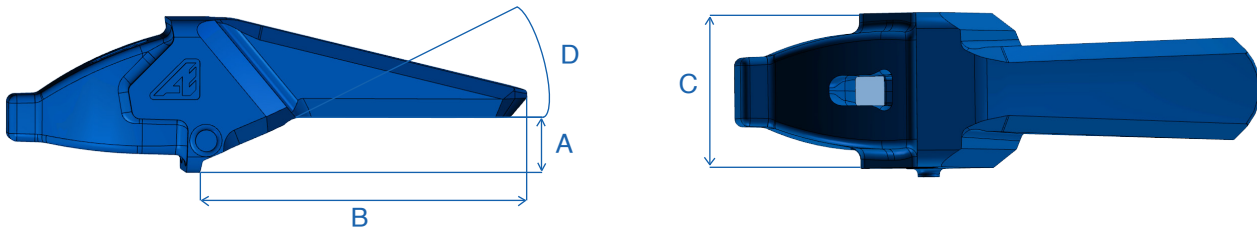

## Flush Adapters Compatibility

The reference varies depending on the excavator's weight.





 t	Reference	Teeth reference	 KG	A mm	B mm	C mm	D degrees
≤ 3	<b>A101</b>	<b>P103</b>	<b>0,75</b>	<b>16</b>	<b>98</b>	<b>45</b>	<b>23°</b>
3-10	<b>A201</b>	<b>P203</b>	<b>1,65</b>	<b>20</b>	<b>122</b>	<b>56</b>	<b>23°</b>

## Keys

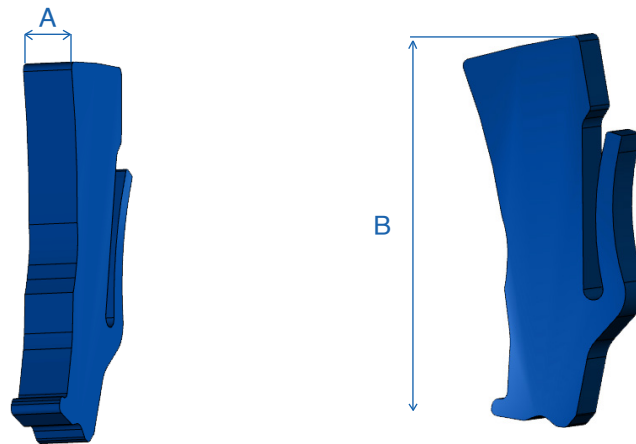
This tip is easily attached to the adapter by vertical insertion.  
The key is held in place by an elastic strip.



 t	Reference	 KG	A	B
≤ 3	<b>C101</b>	<b>0,03</b>	<b>6</b>	<b>45</b>
3-10	<b>C201</b>	<b>0,05</b>	<b>8</b>	<b>56</b>

Technical data and visuals are non-contractual and subject to change without prior notice.



+33 (0)3 24 33 64 30  
 contact@arden-equipment.com  
 9 avenue de l'Industrie FR - 08000 Charleville-Mézières  
 www.arden-equipment.com

